



Main Features:-

- ◆ Full bore 2pc, flanged PN16 1/2" to 8"
- ◆ GGG-40 Ductile Iron Body, SS 304 Ball/stem
- ◆ PTFE+ 15% GF ball seats, FKM (Viton) seal
- ◆ ISO Mount for direct mount actuation
- ◆ Blow out proof stem

*Temperature and pressure determined by valve body, seat etc.



SERIES: 80034

MANUFACTURER: **GENEBRE**

Suitable Applications & Approvals:



HVAC



OIL



GAS



INDUSTRY



ATEX—Not suitable

VALVE MATERIALS & DIMENSIONS

ITEM SECTION MATERIAL ADDITIONAL INFO / OPTIONS

1	Body	Ductile Iron GGG-40	Epoxy Painted
2	Cap	Ductile Iron GGG-40	Epoxy Painted
3	Ball	SS 1.4308	Polished
4	Stem	SS 304	-
5	Ball Seat	PTFE + 15% GF	2825 spare seat kit
6	Gasket	PTFE	2825 spare seat kit
7	Thrust Washer	PTFE	2825 spare seat kit
8	O Ring	FKM (Viton)	2825 spare seat kit

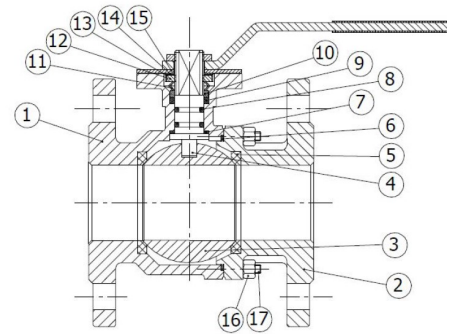

REF	SIZE	D	A	L	M	ISO	h	CxC	Kg
80034-04	1/2"	95	80	115	170	F04	9.5	9 x 9	2.3
80034-05	3/4"	105	80	120	170	F04/F05	9.5	9 x 9	2.8
80034-06	1"	116	90	125	170	F04/F05	11.5	11 x 11	4.1
80034-07	1 1/4"	140	102	130	200	F05/07	11.5	14 x 14	5.4
80034-08	1 1/2"	150	110	140	200	F05/07	15.5	14 x 14	6.9
80034-09	2"	165	120	150	200	F05/F07	15.5	14 x 14	9.3
80034-10	2 1/2"	185	140	170	380	F07/F10	18.5	17 x 17	14.0
80034-11	3"	200	150	180	380	F07/F10	18.5	17 x 17	18.3
80034-12	4"	220	180	190	380	F07/F10	18.5	17 x 17	25.3
80034-13	5"	250	215	325	520	F10/F12	18.5	27 x 27	37.0
80034-14	6"	285	240	350	620	F10/F12	23	27 x 27	49.5
80034-16	8"	340	320	400	800	F12	25	27 x 27	98.0

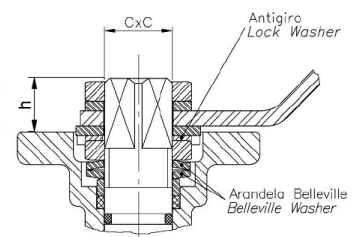
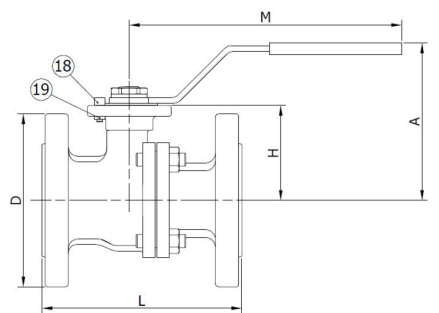

T +44 (0)1386 552369

E sales@allvalves.co.uk

W www.allvalves.co.uk

F +44 (0)1386 554227



Genebre are a global brand of industrial valves with large stocks held for fast delivery on various type of valves, sizes, end connections and materials.

SERIES: 80034

TORQUE / Kv VALUES / PRESSURE & TEMP CHART

REF	SIZE	TORQUE Nm	REF	SIZE	Kv
80034-04	1/2"	5Nm	80034-04	1/2"	19
80034-05	3/4"	8Nm	80034-05	3/4"	40
80034-06	1"	10Nm	80034-06	1"	65
80034-07	1 1/4"	14Nm	80034-07	1 1/4"	110
80034-08	1 1/2"	20Nm	80034-08	1 1/2"	180
80034-09	2"	30Nm	80034-09	2"	365
80034-10	2 1/2"	36Nm	80034-10	2 1/2"	495
80034-11	3"	60Nm	80034-11	3"	970
80034-12	4"	95Nm	80034-12	4"	1620
80034-13	5"	150Nm	80034-13	5"	2530
80034-14	6"	210Nm	80034-14	6"	4050
80034-16	8"	410Nm	80034-16	8"	8650

TORQUE :

- The liquid listed in the table are initial breakaway torques, taken with liquids and lubricant media.

- Please regard these as approximate values, as the objective value on different factors like pressure, medium, rubber,

KV VALUES:

- The Kv values (M3 per hour) is the flow of water at a temperature of 5C to 30C (41F to 86F) at p of 1 bar

- For further information, please email sales@allvalves.co.uk

PRESSURE AND TEMPERATURE CHART

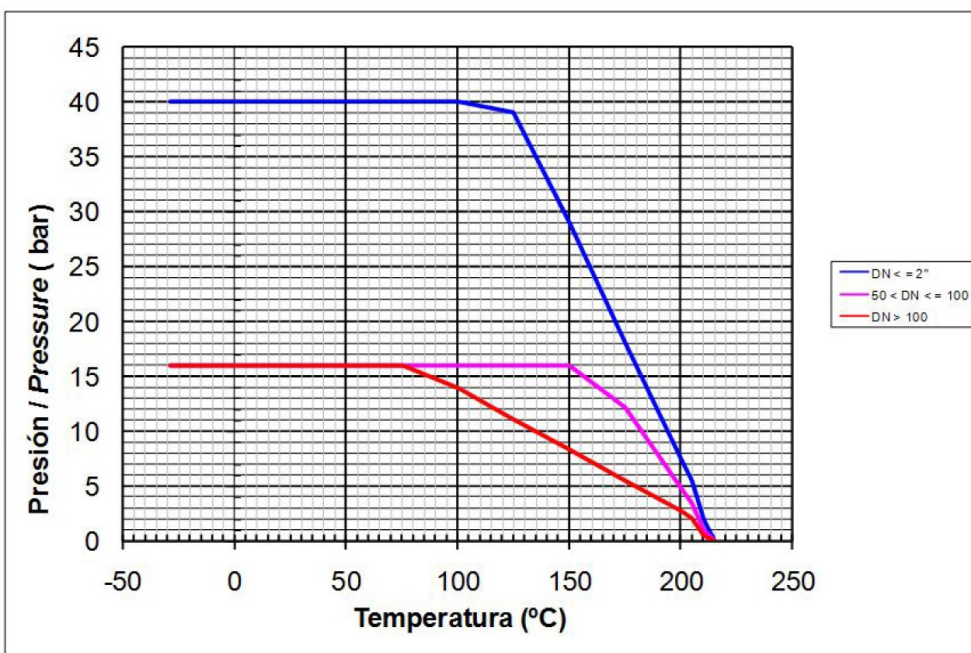

(1 bar = 0,1 MPa ; 1 MPa = 1 N/mm²)

ATEX APPROVED?

No, for ATEX requirements, you should consider our Genebre 2528 series, which is fully ATEX certified. The Genebre 2528 PN16 and 2528A ANSI 150 ball valves are also available 1/2" to 8" and also are direct mount at all sizes allowing easy actuation.

Remember that the 2525 has a stainless steel ball and stem which offers the same wetted parts as stainless steel ball valves but at a lower cost.



T +44 (0)1386 552369

E sales@allvalves.co.uk

W www.allvalves.co.uk

F +44 (0)1386 554227